

Read this First

This Quick Start Guide describes the installation and configuration of single and dual-head CATx USB KVM extenders:

- SDBX/U1
- SDBX/UA1
- SDBX/U2
- SDBX/UA2

Please follow these instructions to set up your KVM extender. To get the best out of the system, it is *essential* that you configure it correctly.

For more information, you can download the full manual for your product from:

<http://manuals.kvmextender.info>

We strongly recommend that you read the full manual.

If you have any problems or questions, contact your dealer for technical support.

Package Contents

An SDBX USB CATx KVM Extender kit contains the following:

- 1 x Local unit
- 1 x Remote unit
- 1 x Remote unit 5V PSU
- 1 x IEC power cord
- 1 x Quick start guide
- 1 x CPU cable set (1.0m) with USB (A-B) and VGA video (HD15 male/female) connectors
- 1 x CPU video cable (1.0m) with VGA video (HD15 male/female) connectors (*SDBX/U2 and SDBX/UA2 only*)
- 1 x Serial cable (1.0m), DB9 male/female, 1:1 connections (*SDBX/UA1 and SDBX/UA2 only*)
- 1 x Dual audio cable, (1.0m), 3.5mm jack plugs (*SDBX/UA1 and SDBX/UA2 only*)



Power Supply

Connect the supplied 5V PSU to the Remote unit.

The Local unit normally takes power through the PC's USB port. In video only applications, this connection is not used and so an external PSU is required. Please contact Technical Support to obtain a suitable power supply.

Overview

An SDBX USB extension system comprises a Local unit (transmitter) and a Remote unit (receiver). The Local unit connects directly to the computer (or a KVM switch system) using the supplied cable(s). The user console (USB keyboard and mouse, monitor(s) and other HID, audio and serial devices) attaches to the Remote unit. The Remote and Local units communicate video and data information along the connecting CATx cables.

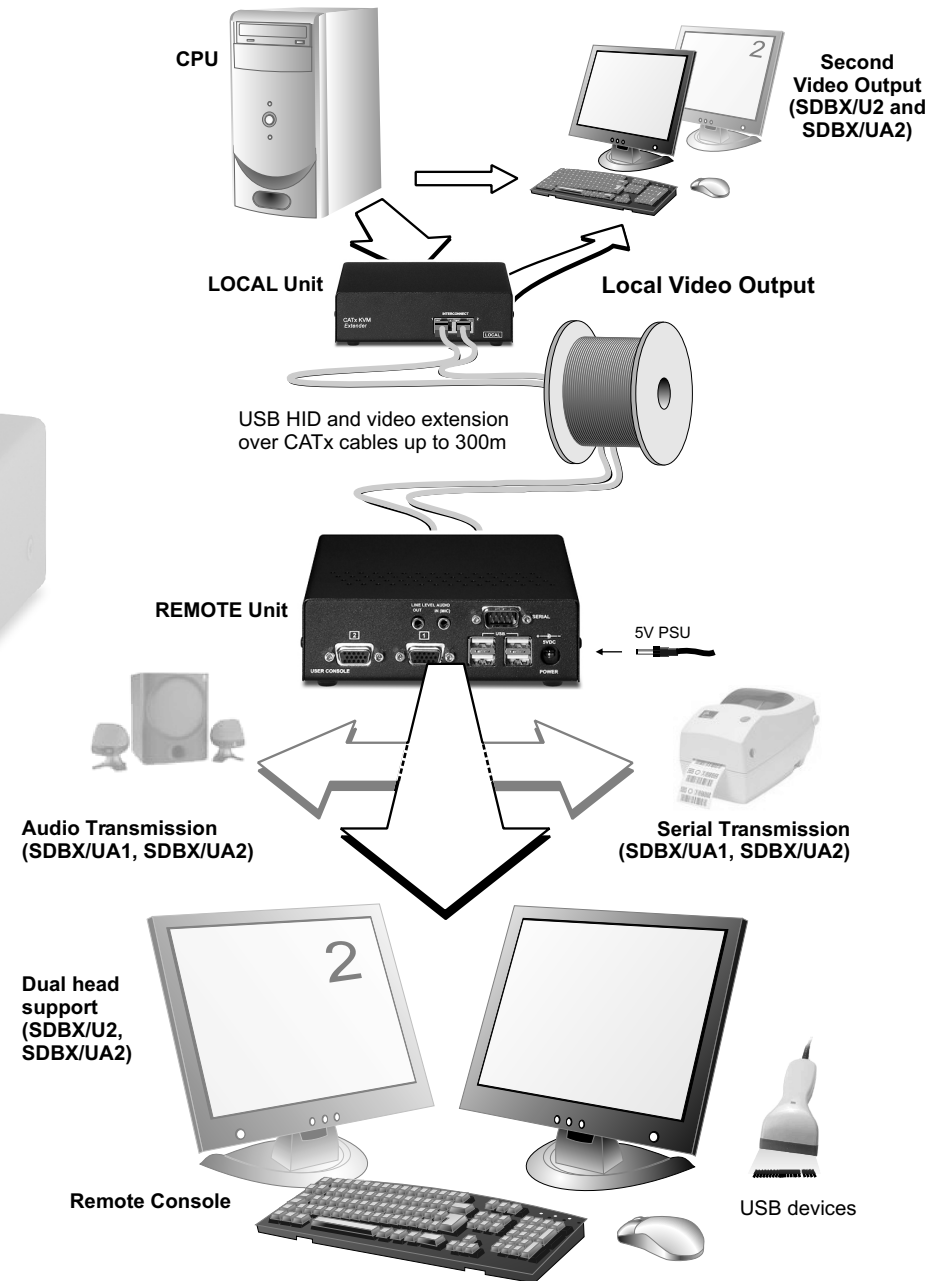

Installation

The SDBX USB product range enables one or two channels of high-resolution video, USB keyboard and mouse, certain HID devices**, stereo audio, and serial port signals to be communicated up to 300m over Category 5, 5e, 6 or higher (CATx) cable.

Local units provide DDC (Display Data Channel) emulation on both video channels. This ensures compatibility with multi-head graphics cards. For non-standard screen resolutions and refresh rates, the Remote unit can read the DDC table from the attached monitor(s), transferring and storing the data in the Local unit.

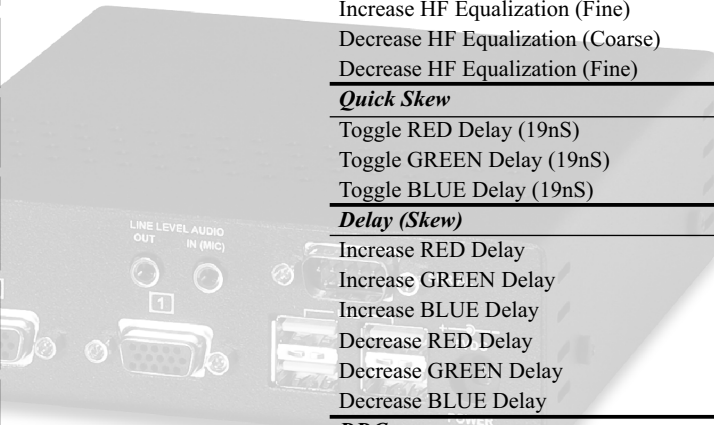
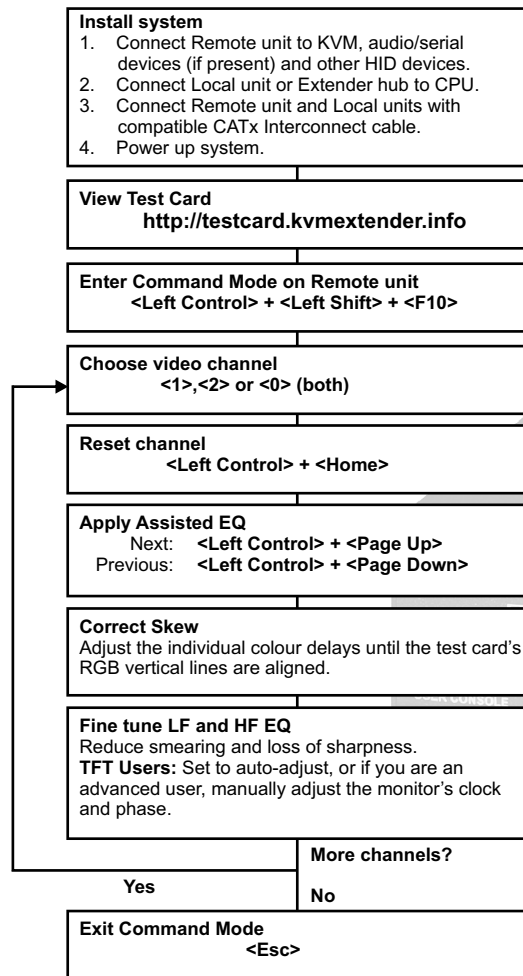

Commands

The following table summarizes the 'hot' key command sequences used in system configuration and video tuning.

Command Mode	
Enter Command Mode	<Left Control> + <Left Shift> + <F10>
Exit Command Mode & Save	<ESC>
Exit Command Mode Without Save	<Left Control> + <ESC>
Video Channel Selection	
Select Channel For Adjustment	<1>, <2>
Select Both Video Channels	<0>
Assisted EQ	
Next Assisted EQ Setting	<Left Control> + <Page Up>
Previous Assisted EQ Setting	<Left Control> + <Page Down>
Reset EQ & Delay Values	<Left Control> + <Home>
Reset EQ Values	<Left Control> + <End>
LF/HF Equalization	
Increase LF Equalization (Coarse)	<L> + <Up Arrow>
Increase LF Equalization (Fine)	<L> + <Right Arrow>
Decrease LF Equalization (Coarse)	<L> + <Down Arrow>
Decrease LF Equalization (Fine)	<L> + <Left Arrow>
Increase HF Equalization (Coarse)	<H> + <Up Arrow>
Increase HF Equalization (Fine)	<H> + <Right Arrow>
Decrease HF Equalization (Coarse)	<H> + <Down Arrow>
Decrease HF Equalization (Fine)	<H> + <Left Arrow>
Quick Skew	
Toggle RED Delay (19nS)	<Left Control> + <R>
Toggle GREEN Delay (19nS)	<Left Control> + <G>
Toggle BLUE Delay (19nS)	<Left Control> +
Delay (Skew)	
Increase RED Delay	<R> + <Right Arrow>
Increase GREEN Delay	<G> + <Right Arrow>
Increase BLUE Delay	 + <Right Arrow>
Decrease RED Delay	<R> + <Left Arrow>
Decrease GREEN Delay	<G> + <Left Arrow>
Decrease BLUE Delay	 + <Left Arrow>
DDC	
Disable DDC Emulation	<Left Control> + <F2>
Enable DDC Emulation	<F2>
Transfer DDC from Monitor to Local Unit	<Left Control> + <D>
Reset Command	
Set Extender To Default State	<Left Control> + <F9>
Private Mode Command	
Toggle Remote Unit Private Mode	<Scroll Lock>

** Please consult the full User Guide for details of additional commands to configure USB devices. You may need to contact Technical Support to determine if your HID device is currently supported.